

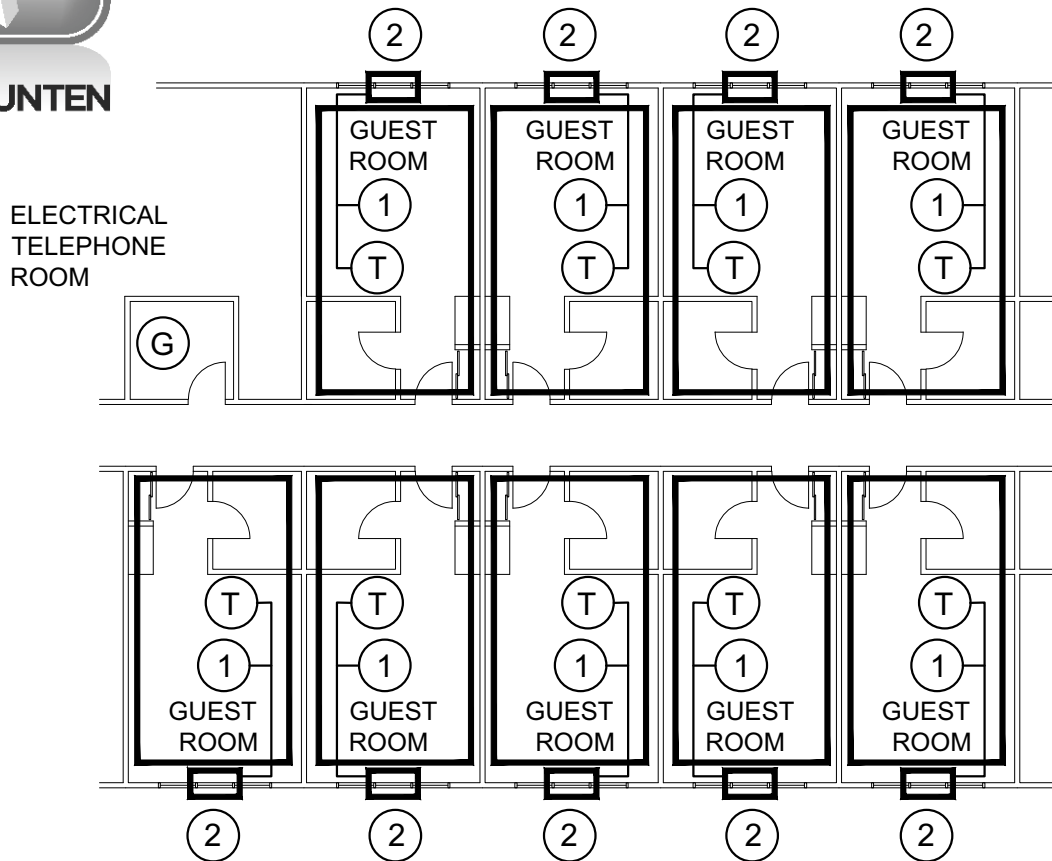

Sample Hospitality - Diagram 300

Single PTAC units serving individual rooms (WIRED thermostat)



- (G)** New FOUNTEN Wireless Gateway (Part No. FS-GATEWAY) - recommend one per building. Unit has 100 to 300 foot maximum wireless range to nearest thermostat depending on building materials. A single Gateway can support up to 2,000 thermostats. Requires 110V electrical outlet and out-bound data connection. Can be located anywhere in building - central location recommended, cannot be surrounded by metal.
- (T)** New FOUNTEN Thermostat (Part No. FS-STAT-32AC) installed at existing thermostat location. Installation requires one thermostat per PTAC unit. Unit will automatically repeat and route signals from other thermostats (100 to 300 foot maximum range), extending the Gateway's communication range beyond its 100 to 300 foot maximum range - establishing an automatic, self-healing, mesh network.
- (1)** Existing wires running from existing PTAC unit to existing thermostat location. Requires cable with minimum of 3 wires.
- (2)** Existing PTAC (Package Terminal Air Conditioner) unit.

Installations in new buildings have similar design recommendations

FOUNTEN 2013